

APEX VALVES PumpBuddy®

Every 6 months check that the valve functions correctly. Gently push the lever down and the valve will open. Release the lever. When the weights are submerged, the valve should close. If the valve fails to shut off completely, it may be necessary to clean or repair it.

Cleaning Instructions

- Unscrew the cap using the Trough Mate tool (see picture A)
- Check that the lever operates freely*
- Remove the diaphragm, clean, inspect for wear or damage* clean filter
- Clean and inspect the seat
- Lightly lubricate the jet centre slide and diaphragm lip seal with silicone grease
- Place the diaphragm in the body
- Screw the cap back onto the valve body
- Tighten with the Trough Mate tool, aligning the flat side of the cap with the body outlet

* If the valve requires new parts, obtain and fit a repair kit (RKPB)

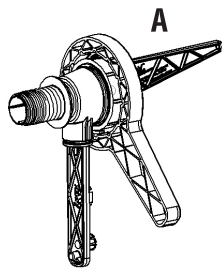
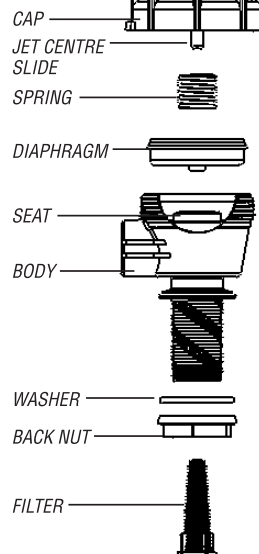

Operating Principle

The PumpBuddy will be closed when both weights are submerged (maximum water level). The valve will remain closed until the bottom weight is exposed (minimum water level). The valve will then open and remain open until the maximum level is reached.

The PumpBuddy valve MUST NOT be fitted to tanks used partially for stormwater detention.

(Detention is the slow release of water run-off to the stormwater drain during and after rainfall events)

Valve installation must be in accordance with local bylaws and council regulations.

Installation Instructions

IMPORTANT

- **Overflow discharge must be visible.**
 - **Pump must have "dry run" protection.**
 - **Water loss is not covered by the manufactures warranty.**
 - **The cord must hang freely.**
1. Install valve horizontally. Do not install on an angle.
 2. Do NOT restrict flow.
 3. Inlet pipe must be clean.
 4. Ensure the washer is fitted on the inside of the tank. (LT model only)
 5. Use thread tape and do not overtighten.
 6. Adjust the cord length to give the minimum desired water level
 7. Adjust small weight for maximum water level and clip the cord into both cleats
 8. Bottom weight must NOT be below tank outlet

